

REFRIGERATOR GUIDE

S75555SKW

WARNING!

This appliance is intended to be used in household and similar applications such as staff kitchen areas in shop, offices and other working environments; farm houses and by clients in hotels, motels and other residential environments; bed and breakfast type environments; catering and similar non-retail applications.

If the supply cord is damaged, it must be replaced by the manufacturer, its service agent or similarly qualified persons in order to avoid a hazard.

DO not store explosive substances such as aerosol cans with a flammable propellant in this appliance. The appliance has to be unplugged after use and before carrying out user maintenance on the appliance.

WARNING: Keep ventilation open, in the appliance enclosure or in the built-in structure, clear of obstruction.

WARNING: Do not use mechanical devices or other means to accelerate the defrosting process, other than those recommended by the manufacturer.

WARNING: Do not damage the refrigerator circuit.

WARNING: Do not use electrical appliances inside the food storage compartments of the appliance, unless they are of the type recommended by the manufacturer.

WARNING: Please abandon the refrigerator according to local regulations because it uses flammable blowing gas and refrigerator.

WARNING: When positioning the appliance, ensure the supply cord is not trapped or damaged.

WARNING: Do not locate multiple portable socket-outlets or portable power supplies at the rear of the appliance.
Do not use extension cord or ungrounded (two prong) adapters.

DANGER: Risk of child entrapment. Before you throw away your old refrigerator or freezer:

- Take off the doors.
- Leave the shelves in place so that children may not easily climb inside.

The refrigerator must be disconnected from the source of electrical supply before attempting the installation of accessory.

Refrigerant and cyclopentane foaming material used for refrigerator are flammable. Therefore, when the refrigerator is scrapped, it shall be kept away from any fire source and be recovered by a special recovering company with corresponding qualification other than be disposed by combustion, so as to prevent damage to the environment or any other harm.

For EN standard: This appliance can be used by children aged from 8 years and above and persons with reduce physical sensory or mental capabilities or lack of experience and knowledge if they have been given supervision or instruction concerning use of the appliance in a safe way and understand the hazards involved .Children aged from 3to 8 years are allowed to load and unload refrigerating appliances.

For IEC standard: This appliance is not intended to be used by persons (including children) with reduced physical, sensory or mental capabilities, or lack of experience and knowledge, unless they have been given supervision or instruction concerning use of the appliance by a person responsible for their safety.

Children should be supervised to ensure that they do not play with the appliance.

TO avoid contamination of food, please respect the following instructions:

Opening the door for long periods can cause a significant increase of the temperature in the compartments of the appliance.

- Clean regularly surfaces that can come in contact with food and accessible drainage systems.
- Clean water tanks if they have not been used for 48 h; flush the water system connected to a water supply if water has not been drawn for 5 days.
- Store raw meat and fish in suitable containers in the refrigerator, so that it is not in contact with or Drip onto other food.
- Two-star (☆☆) frozen-food compartments are suitable for storing pre-frozen food, storing or making ice cream and making ice cubes.
- One-★, two- (☆☆) and three-star (☆☆☆) compartments are not suitable for the freezing of fresh food.
- If the refrigerating appliance is left empty for long periods, switch off, defrost, clean, dry, and leave the door open to prevent mould developing within the appliance.



Warning: Risk of fire/ flammable materials

Introduction

Thank you for choosing this appliance. It has been designed to give years of trouble-free use provided it is installed and Maintained correctly.

Please read these instructions carefully before installing or using your appliance. It is advisable to keep your purchase and installation receipts with these instructions in a safe place for future reference. Included is some important safety information in addition to guidelines and Recommendations that will enable you to take full advantage of all the Functions available.

This quality appliance has been tested and certified to meet all applicable Europe electrical and safety standards.

This appliance must be installed and connected in accordance with current regulations by a qualified electrician.

After unpacking the appliance ensure that there is no visible damage. If the appliance has been damaged during transit, do not use it, contact your retailer immediately.

Description of the Appliance

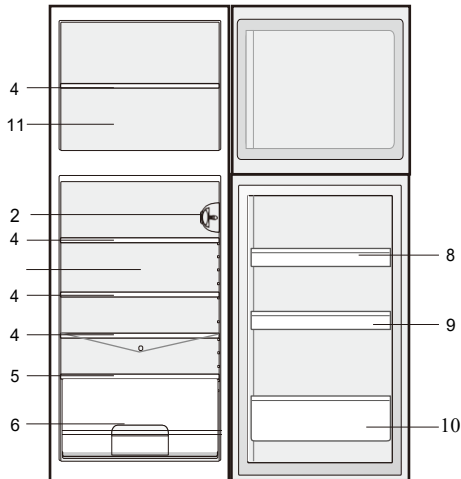
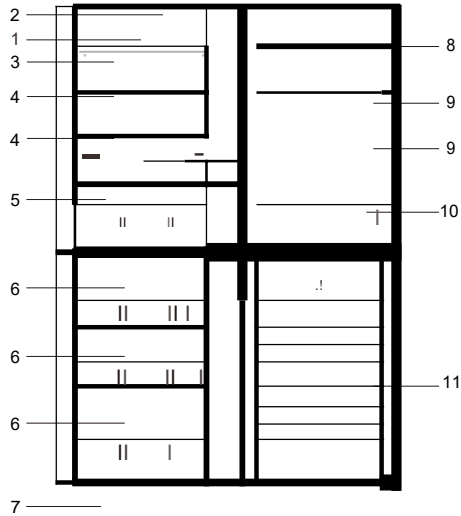

Refrigerate Compartment 2 Thermostat Control (Interior Light) 3 Interior Steel Wire Shelf
 4 Interior Glass Shelf 5 Salad Crisper Box with Glass Shelf 6 Salad Crisper Box 7 Levelling Feet
 8 Door Storage (above) 9 Door Storage (Middle) 10 Door Storage (under) 11 Freezer Compartment

Important notice:

- 1, the product appearance and specifications may be varied without notice to raise the product quality.
- 2, the product appearance and specifications may be varied with that of the related energy efficiency test or the related safety tested.

CONTENTS:

Section 1. Installation

Section 2. Safety Advice

Section 3. Operating the Appliance

Section 4. Maintenance

Section 1. Installation

IMPORTANT! This appliance must be left to stand in an upright position for at least 4 hours before being switched on for the first time.

This appliance has been designed for Domestic Use Only.

Remove all packaging and securing tape from the appliance.

Wash the interior of the appliance with luke warm water containing a small amount of bicarbonate soda (5ml to 0.5 liters of water).

Position the appliance in a dry atmosphere and out of direct sunlight.

Do not position next to a cooker or other sources of heat, i.e. radiator.

This appliance should not be sited in a cold atmosphere, i.e. garage or shed. Doing so may cause the freezer unit to under freeze.

If positioned next to another fridge or freezer, leave a minimum gap of 2cm between the appliances in order to avoid condensation.

A clearance of 50mm should be left above the appliance. If this cannot be achieved you should ensure a clearance of 25mm is maintained on each side of the appliance.

Fit the plastic wall spacers to the condenser on the rear of the appliance, this will ensure an air gap between the appliance and the wall.

Do not place or store heavy items on the top of this appliance.

Ensure that the appliance is positioned on a firm flat floor.

This appliance must be level. Adjust the level by screwing the adjustable feet up or down (use your fingers or a suitable spanner).

Ensure that the appliance is upright and both feet are in firm contact with the floor so that the cabinet is stable.

Connect the plug to an adjacent 13amp socket out let and ensure that the appliance is not standing on the supply cable.

Section 2. Safety Advice

Please read this booklet thoroughly before installing and switching on the appliance. The manufacturer accepts no responsibility for incorrect installation and usage.

If this appliance is to replace an old refrigerator with a lock, as a safety measure break or **remove the lock and/or door** before disposal.

Your old appliances contain insulation gases and refrigerant that must be disposed of correctly. Please ensure that the refrigerant circuit is not damaged before the appliance is taken away for correct disposal in line with current legislation. If there is any doubt contact your Local Authority for instructions.

This appliance may contain the refrigerant isobutene <R600a/R134a. This is a natural gas with a high level of environmental compatibility; however, caution is required as isobutene is a flammable gas. It is essential to ensure that refrigerant tubes are not damaged during transportation and the installation of the appliance. In the event That the refrigerant circuit is damaged, avoid naked flames or sources of ignition and ventilate the room in which the appliance is situated.

If using an adaptor, this must be used in accordance with the manufacturer's instructions and ensure that the electrical circuit is not overloaded as this could cause overheating.

Do not twist or bend the cables, and keep them away from hot surfaces.

Do not plug in or unplug this appliance with wet hands.

Following installation make sure that the power cable is not trapped underneath the appliance.

Ensure the appliance is left in an upright position for at least 4 hours before you switch it on.

The appliance has to be unplugged after use and before carrying out user maintenance on the appliance.

Section 3. Operating the Appliance

3.1. Switching on the Appliance

Allow the appliance to stand upright for a minimum of 4 hours before you switch it on.

Plug in the appliance and switch on at the mains supply.

Set the thermostat control to the required setting as detailed in the Temperature Control section (3.2.1).

Leave the appliance for approximately 4 hours for the correct temperature to be reached.

3.2. Temperature Control

The temperature selector knob is located on the lamp unit inside the refrigerator - See Description of the Appliance on page 2).

Setting "0" : Unit Off

Setting "1" : Unit On - Warmest Temperature

Setting "3 or 4" : Normal Operation (adequate for most situations)

Setting "7" : Coldest Temperature

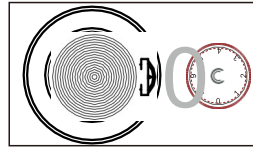
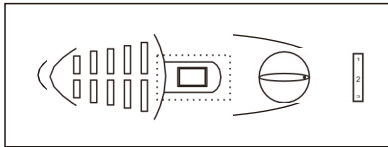

Important!

During high ambient temperatures e.g. on hot summer days, it may be necessary to set the thermostat to the coldest setting (the "7"). This may cause the compressor to run continuously in order to maintain a low temperature in the cabinet.

3.3. Storing & Freezing Food in the Freezer

This appliance has a three star freezer that is suitable for the long-term storage of frozen food items. It can also be used for freezing and storing fresh food items.

3.4. Normal Operating Sounds

You may hear faint gurgling or bubbling sounds when the refrigerant is pumped to the cooling system and through the coils or tubing at the rear of the appliance. When the compressor is in operation you may hear a slight whirring sound or pulsating noise. The thermostat controls the operation of the compressor, and you may hear a slight click as it cycles in and out.

3.5. Energy Saving Advice

Do not install the appliance close to sources of heat, such as a cooker, dishwasher or radiator.

Locate the appliance in a cool well-ventilated room and make sure that the air vents are clear.

Try to avoid keeping the doors open for a long time, warm air will enter the cabinet and may cause a build-up of ice as well as affecting the energy consumption. Ensure there are no obstructions preventing the doors from closing properly.

Ensure that the door seals are clean and there are no tears or splits.

Keep the most perishable foods, (those with a short shelf-life, such as cooked meals), in the coldest part of the fridge. The Salad Crisper Box is

The warmest part of your fridge and should be used for vegetables, salads and fruits etc. (see Description of Appliance on Page 2)

Do not overload the fridge: the cooling air that circulates to keep the fridge cold gets blocked and pockets of warm air form.

Do not put hot food into the fridge or freezer? Let it cool down first.

3.6. In the Event of a Power Failure

If there is a power failure, keep the doors closed. When the power has been restored the appliance will start to operate but it may take some time to achieve the pre-set operating temperature. Check the condition of your stored food items and liquids.

Section 4. Maintenance

Before any maintenance or cleaning work is carried out, DISCONNECT the appliance from the ELECTRICITY supply.

4.1. Internal Cleaning

Clean the interior and accessories with warm water and bicarbonate of soda (<5ml to 0.5 liter of water). Rinse and dry thoroughly. Do not use detergents, abrasive powders, highly perfumed cleaning products, wax polishes or cleaning products containing bleach or alcohol.

4.2. External Cleaning

Wash the outer cabinet with warm soapy water. Do NOT use abrasive products. There may be sharp edges on the underside of the product, so care should be taken when cleaning. Once or twice a year dust the rear of the appliance and the compressor at the back of the appliance, with a brush or vacuum cleaner, as an accumulation of dust will affect the performance of the appliance and cause increased energy consumption.

4.3. Defrosting

The fridge compartment will not automatically defrost itself. However, you will need to defrost the freezer periodically. When ice buildup in the freezer exceeds 3-5mm, empty the contents and switch off the appliance, leave the door open and allow the ice to melt. Place the frozen foods items in a cool-bag or wrap them in thick newspaper. **Do not use sharp objects to scrape the ice away. Clean and** dry the interior, close the door and turn on the power to the appliance. When the power has been restored the appliance will start to operate but it may take some time to achieve the pre-set operating temperature.

4.4. When the appliance is not in use

When the appliance is not in use for long periods, remove the contents, disconnect from the electricity supply and clean the appliance, leaving the door ajar until you wish to use the appliance again.

4.5. Changing the Interior Light (Except Freezer compartment)

Switch off the power supply to the appliance

Remove the plastic light cover

Remove the lamp from the light unit.

Replace the lamp with a suitable replacement <1.5W

Refit the cover and switch the appliance back on.

4.6. What to do if something goes wrong

There is no power to the appliance:

- Check there is not a power cut
- Check there is power to the electric socket/appliance
- Check the fuse in the plug (Must be 13 amp)
- Check that the thermostat has been set to position 1 or above - See section 3.2.1

the compressor runs continuously:

- Are the doors closed correctly?
- Have large quantities of food recently been added to the appliance? - If yes, allow the interior temperature to recover
- Have the appliance doors been opened frequently? - If yes, allow the interior temperature to recover
- Check that the Thermostat Control has not been set to maximum

There is excessive frost/ice buildup:

- Ensure that the doors have been closed correctly
- Ensure that the door seals are clean and sealing correctly
- Check that the Thermostat Control has not been set to maximum

The appliance is making a noise:

- Refer to Normal Operating Sounds, section 3.4
- Ensure that the appliance has been installed correctly - See section 1).

If after the above checks there is still a fault please contact our service department in Dublin on 01-4505327.

Insurance

Any warranty provided with this product does not cover loss of fridge/freezer content.

Any claim for loss, damage, costs or expenses of an indirect or consequential nature including any economic loss or damage to foodstuffs or any other goods is excluded. We recommend that you inspect your fridge/freezer regularly to check that it is working correctly, losses can result from deterioration following breakdown or accidental failure of the appliance, fuses, plugs or public electricity supply, and these can be covered by your standard home insurance or might require extra cover. Check with your insurance provider.

Important Note:

This appliance is marked according to the European directive 2002/96/EC on Waste Electrical and Electronic Equipment < WEEE). By ensuring this product is disposed of correctly, you will help prevent potential negative consequences for the environment and human health, which could otherwise be caused by inappropriate waste handling of this product.

The symbol on the product, or on the documents accompanying the product, the Crossed out Wheelie Bin, indicates that this appliance may not be treated as household waste. Instead it shall be handed over to the applicable collection point for the recycling of electrical and electronic equipment.

Disposal must be carried out in accordance with local environmental regulations for waste disposal. For more detailed information About treatment, recovery and recycling of this product, please contact your local authority, your household waste disposal service or the retailer where you purchased the product.



We continuously try to improve our products for the benefit of our customers. For this reason we reserve the right to make changes to any product at any time, without notice

Supplied By www.servisappliances.ie